

Universal bracket for eWalk MCG1900

Included.

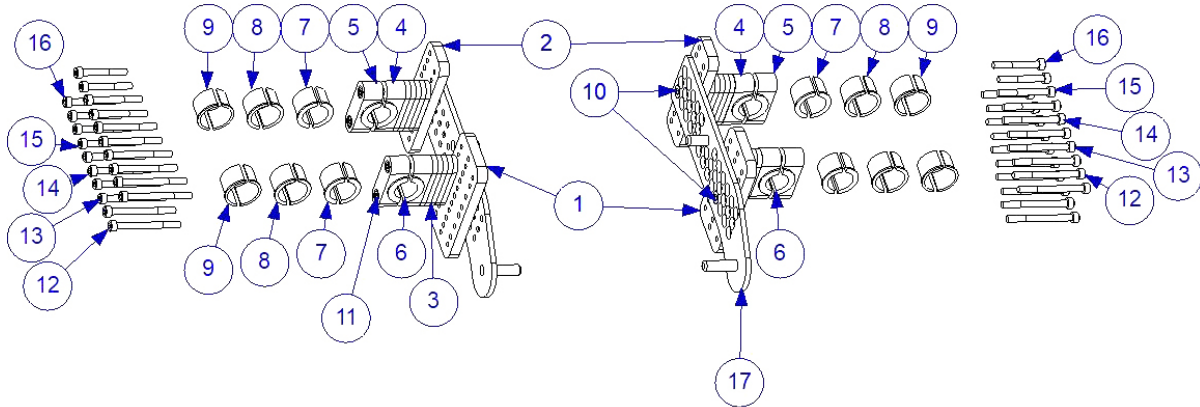

Item No.	Part Number	Qty	Description
1	MCG1903	2	Rear Plate
2	MCG1904	2	Front Plate
3	MCG1905	20	Spacer Plate
4	MCG1906	4	House
5	MCG1907	4	House Clamp
6	MCG1922	8	Spacer 22
7	MCG1925	8	Spacer 25
8	MCG1928	8	Spacer 28
9	MCG1930	8	Spacer 30
10	XSFM6X14	4	Screw Countersunk M6 x 14
11	MC6SM6X70	8	Screw Socket M6 x 70
12	MC6SM6X65	8	Screw Socket M6 x 65
13	MC6SM6X60	8	Screw Socket M6 x 60
14	MC6SM6X55	8	Screw Socket M6 x 55
15	MC6SM6X50	8	Screw Socket M6 x 50
16	MC6SM6X45	8	Screw Socket M6 x 45
17	MCG1902R	1	Main bracket w pins Right
18	MCG1902L	1	Main bracket w pins Left

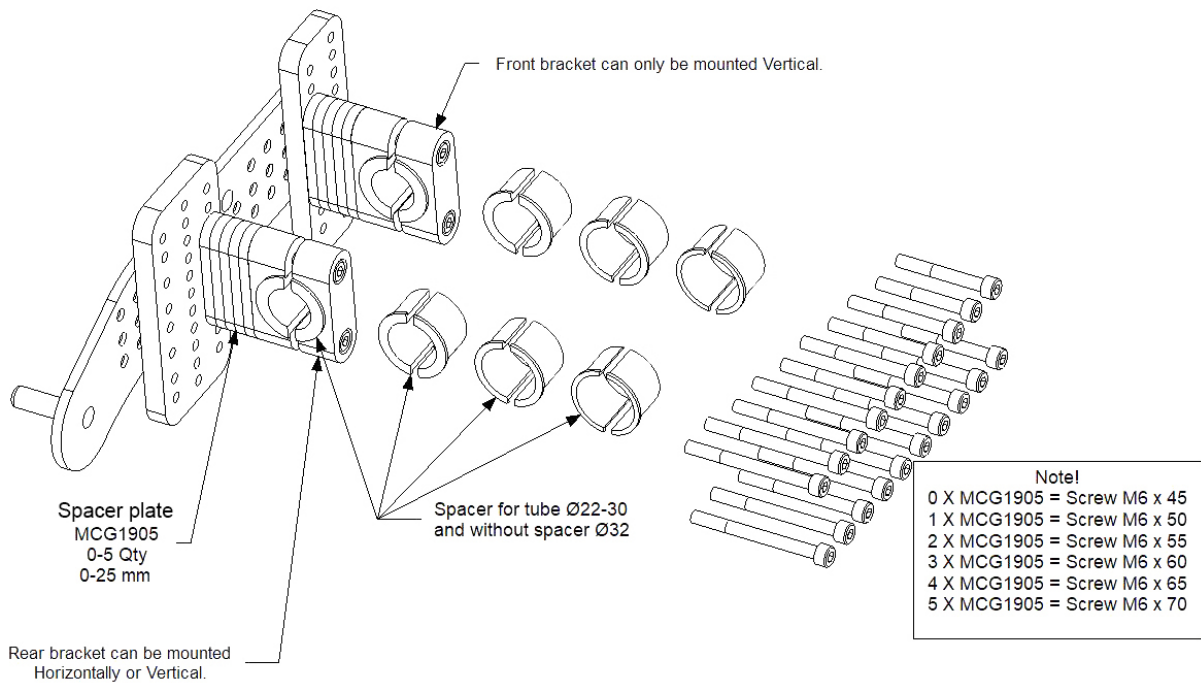

1. Select spacers if you need it for frame tube.
 2. Select spacer plates if you need it for clearance from frame tube or anti-tip devices.
 3. Assembly as picture below.
- If you have the rear pin at 195 mm and the front pin at 225 mm, then the bracket is in optimal position for a vertical mounting.

